







Ownashare For further details contact Linda 07800902323 [www.ownasharecruising.co.uk](http://www.ownasharecruising.co.uk)

]	Layout	19 <sup>th</sup> February 2024	Price	Monthly Costs*1	HOLIDAY DATES 2024	Status	Base
Adderbury	Semi Trad		£1000	£140.43	2024 22 <sup>rd</sup> March, 14 <sup>th</sup> June 23 <sup>rd</sup> & 30 <sup>th</sup> August	Special share	Dunchurch Pools
Beeston Castle	Semi Trad PET FREE		£995	£150	2024 26 <sup>th</sup> April, 3 <sup>rd</sup> May, 1 <sup>st</sup> Nov	Standard share	Dunchurch Pools
Castleber	Cruiser stern Pet Friendly		£1900	1200 per annum, Payable in 3, 6 or 12 <sup>th</sup> monthly payments 2024 £100 per month	9 <sup>th</sup> Feb, 19 <sup>th</sup> & 24 <sup>th</sup> April, 18 <sup>th</sup> Oct	Standard 1/12 <sup>th</sup>	Nantwich
Farndon	Semi trad pet friendly		£1500	£140	8 <sup>th</sup> March 12 <sup>th</sup> & 19 <sup>th</sup> July Awaiting 4 <sup>th</sup> week	Standard 1/12	Nantwich
Huxley	Semi Trad Pet friendly		£1500	£154	24 <sup>th</sup> & 31 <sup>st</sup> May, 30 <sup>th</sup> Aug, 8 <sup>th</sup> Nov	Standard 1/12 <sup>th</sup>	Dunchurch Pools





Ownashare For further details contact Linda 07800902323 [www.ownasharecruising.co.uk](http://www.ownasharecruising.co.uk)

Heartsease due to repaint April 2024	Semi trad Pet friendly		<b>£1900</b>  <b>1500</b>	£155	9 <sup>th</sup> Feb, 3 <sup>rd</sup> May, 24 <sup>th</sup> July, 1 <sup>st</sup> November OR 1 <sup>st</sup> March, 26 <sup>th</sup> April, 16 <sup>th</sup> & 23 <sup>rd</sup> August	Standard 1/12 <sup>th</sup>	Kings Bromley Marina
Minuet	Cruiser Stern Pet Friendly		<b>£2500</b>	£150  £130	16 & 23 <sup>rd</sup> August, 25 <sup>th</sup> Oct OR 19 <sup>th</sup> April, 17 <sup>th</sup> & 24 <sup>th</sup> May, 22 <sup>nd</sup> Nov OR 31 <sup>st</sup> May, 20 <sup>th</sup> Sep, 8 <sup>th</sup> Nov	School hol share  Standard 1/12 <sup>th</sup>	Dunchurch
Sorceress	Semi Trad Pet Friendly		<b>£1000</b>	£190 Saving	23 <sup>rd</sup> Feb, 21 <sup>st</sup> & 28 <sup>th</sup> June, 8 <sup>th</sup> Nov OR 15 <sup>th</sup> March, 5 <sup>th</sup> & 12 <sup>th</sup> July 11 <sup>th</sup> Oct. OR 22 <sup>nd</sup> March, 19 <sup>th</sup> & 26 <sup>th</sup> July, 1 <sup>st</sup> Nov	Standard 1/11 <sup>th</sup> share	Dunchurch Pools
Shearwater	Semi trad pet friendly		<b>£500</b>  <b>£850</b>	£145  £145	23 <sup>rd</sup> February, 19 <sup>th</sup> April, 23 <sup>rd</sup> August, 1 <sup>st</sup> Nov  26 <sup>th</sup> April, 2 <sup>nd</sup> August, 25 <sup>th</sup> Oct, 6 <sup>th</sup> Dec	1/12 <sup>th</sup> share	Kings Bromley



Ownashare For further details contact Linda 07800902323 [www.ownasharecruising.co.uk](http://www.ownasharecruising.co.uk)

Symphony	Semi trad pet friendly		<b>£1000</b>	£150	Awaiting 4 <sup>th</sup> week 22 <sup>nd</sup> March, 10 <sup>th</sup> May, 30 <sup>th</sup> August	1/12 <sup>th</sup> standard share	Kings Bromley Marina
Rufford	Semi Trad		<b>£1200</b>  <b>£2000</b>	£165	6 <sup>th</sup> July (option on this wk) 27 <sup>th</sup> July, 24 <sup>th</sup> August, 12 <sup>th</sup> Oct Or 1 <sup>st</sup> June 14 <sup>th</sup> September, 26 <sup>th</sup> Oct	Standard 1/12 <sup>th</sup>	Norbury Wharf



Ownashare For further details contact Linda 07800902323 [www.ownasharecruising.co.uk](http://www.ownasharecruising.co.uk)

Cruiser stern/ reverse layout

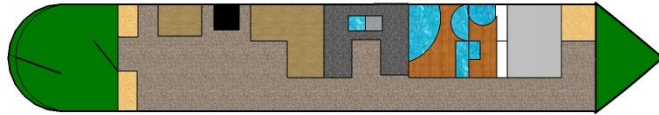

Semi Trad /Standard layout

